

BARFEEDERS THAT PRODUCE MORE PARTS & INCREASE PROFIT

- ⇒ **AUTOMATIC LONG BAR FEEDERS ARE USED BY OVER 80% OF EUROPEAN MANUFACTURERS**
- ⇒ Preferred bar feeders of Europe's Technic Valley.
- ⇒ Efficiency takes precedence over floor space. Short feeders are out; long feeders are in!
- ⇒ Top automatic long bar feeders are innovative, **ROBUST & versatile!**
- ⇒ Suitable to support rotating bar at high working speeds.
- ⇒ Over 200 installed in the USA.



FUSION MODEL

Suitable for **fixed-headstock** CNC lathes

Working envelope (bar-stock ϕ) from **6mm to 52mm**

Single-rack, multiple-racks, forklift/crane access and bundle type bar magazine options.

X-FILES MODEL

Suitable for **fixed-headstock** CNC lathes

Working envelope (bar-stock ϕ) from **10mm to 100mm**

Single-rack, multiple-racks, forklift/crane access and bundle type bar magazine options.



INFINITY MODEL

Suitable for **sliding-headstock** CNC lathes

Working envelope (bar-stock ϕ) from **3mm to 45mm**

Gravity type (single-rack) and multiple-racks bar magazine included. Walking beam type solution available as "option" for small bar stock diameters

Available in 3m and 4m (12 ft) lengths

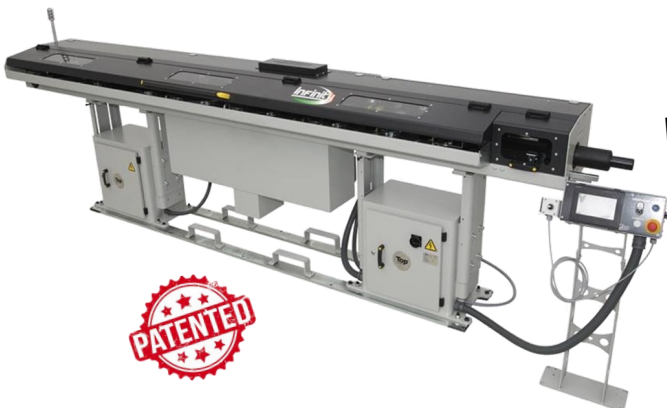

TOP'S PATENTED SOLUTION LOWERS COSTS!

- 1 Minute Changeovers
- No Channel Guides
- No Spindle Liners

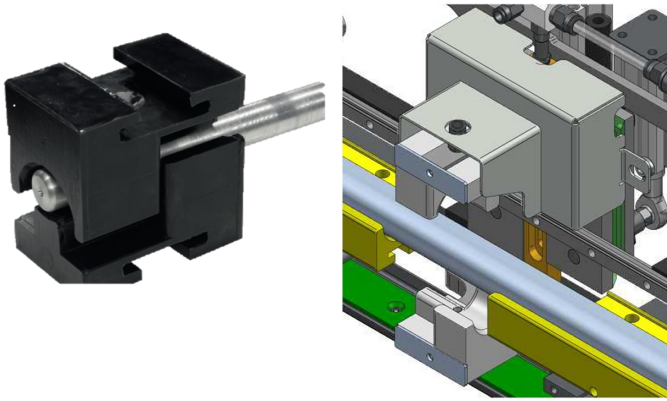

The patented **self-adjustable guide bushes** system developed by Top Automazioni will allow customers to run the entire bar stock diameter capacity of the bar feeder with **only one (1) set** of guide bushes reducing costs and lowering up front time.

The self-adjusting guide bushes are adjustable directly from HMI panel (mm by mm). The bushes are made in

2 BETTER SUPPORT FOR BAR STOCK & BAR PUSHER DURING CUTTING PROCESS

Tops' Fusion and X-files bar feeders are equipped with five to nine (quantity will change based on bar feeder length) self-centering guide bushes module, so they are constantly supporting both the bar-pusher and the bar every 250mm during cutting process vs standard bar feeders which have only two contact points.

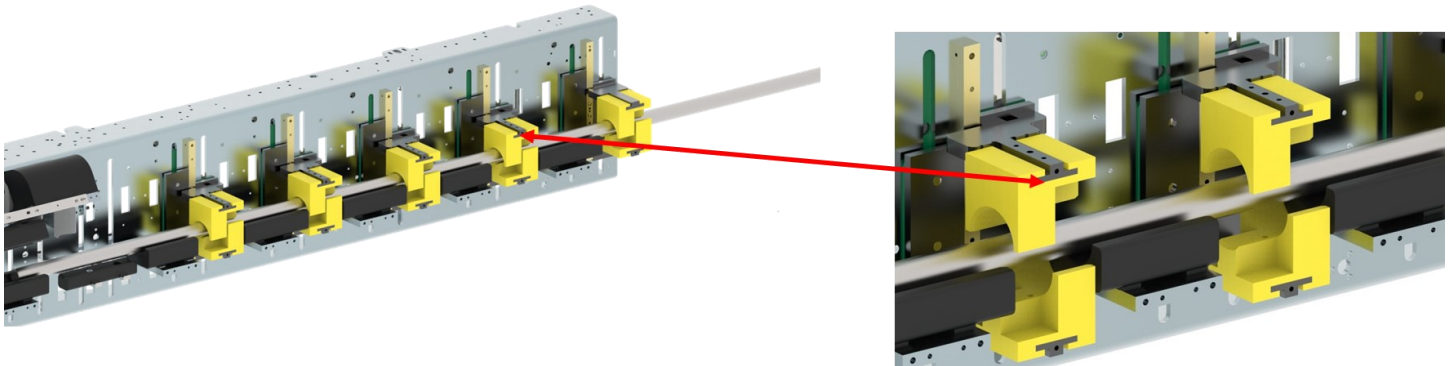

3 FLEXIBILITY! FINE-TUNE BAR SUPPORT DIAMETER AT NO EXTRA COST

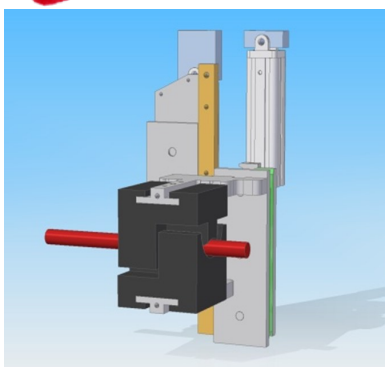

Through the HMI panel the customer can program the best guide bushes ID to run bar stock smoothly. The patented solution requires no extra kit vs standard bar feeds which require extra kit/costs.

Thanks to guide bushes automatic adjustment, setting the new diameter from HMI is done in **ONE MINUTE** vs manual set up with standard bar

